

XCLUSIVE 88i²

ift
ROSENHEIM

Main Entrance

FEATURES + BENEFITS

OUTSTANDING THERMAL INSULATION

Uf : > 1.69 W/m²K
Ud* : 1.2 W/m²K with panel 28mm (Up: 1.0)
Ud* : 0.95 W/m²K with panel 77mm (Up: 0.6)

Three insulation levels:

- ▶ Optimized **foam-filled insulation zone (ELVIAL I² Technology)** that ensures excellent isothermal flow of the window.
- ▶ **Multi-chamber polyamide bars**, maximum size **34mm** with glass fibers reinforcement 25%, (PA6.6 25 GF), for excellent insulation and extra rigidity.
- ▶ Specially designed **central gasket with 5 cavities** that covers all the polyamide surface and **glazing/panel gaskets with fins**, for effective heat transfer minimization.

SECURITY

Cerified Security Level RC3 (WK3) thanks to its compatibility with wide range of security and anti-burglar locks. Compatible with electronic access control systems. Locking System: **Locks "U" type** 24x6mm.

DURABILITY FOR A LIFETIME

HH: Width up to 1.450mm /sash ■ Height up to 2.550mm
 Weight up to 150kg/sash
T4: Width up to 1.400mm /sash ■ Height up to 2.350mm
 Weight up to 220kg/sash
Glazing up to 60mm Panel up to 77mm

Perfect functionality:

- ▶ **3 Axis polyamide alignment corners** with channels for **glue inflow**, for extra rigidity of the final product.
- ▶ Re-enforced profile wall thickness (1.5 – 1.8mm) with **high values of moment of inertia**, suitable for wide and complex constructions.

ADVANCED SEALING SYSTEM, CONSISTED OF:

- ▶ **3 Level Sealing System** with EPDM gaskets and **continuous central gaskets on Sash, Frame and Threshold**
- ▶ **EPDM corners** for both central gaskets and the outer glazing gasket
- ▶ Innovative **Mullion End Cap made of TPV** material, sealing perfectly onto the profile, ensuring excellent water tightness

BASIC DEPTH FRAME: 77mm SASH: 77mm

MINIMUM FACE WIDTH K-Φ: 141.2mm T: 82mm

EXTRA FEATURES

- ▶ **Anti-distortion** glass fiber **polyamides** used on ALL sash profiles, in order to avoid the malfunctions caused by the profile expansion and contraction due to extreme temperature changes (banana effect).
- ▶ **Easy-access** threshold of 20mm.
- ▶ Option of **automatic wind break**.
- ▶ Optional use of various hinges (**hidden hinge, external heavy duty hinge**).

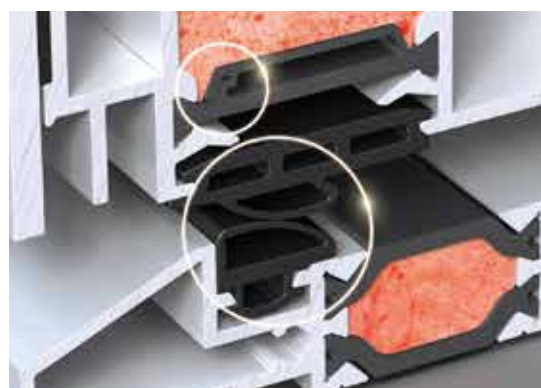
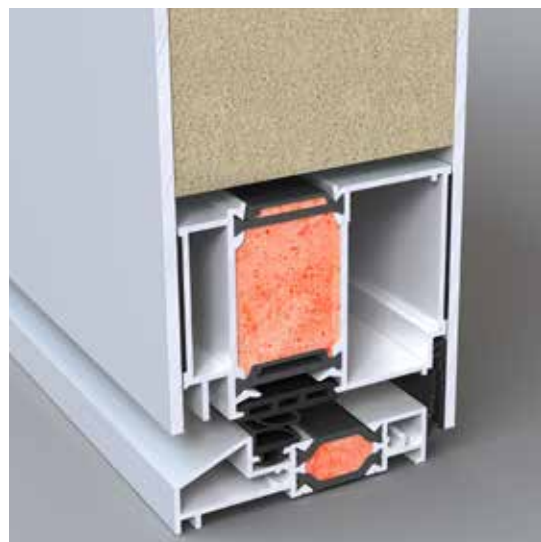

XCLUSIVE 88i² Main Entrance

DESIGN FREEDOM

- ▶ **Upgraded face-fitted door** constructions that add value on the building's image
- ▶ **Inward-opening** and **Outward-opening** versions are available in **ALL typologies**
 - > **Single** sash doors
 - > **Double** sash doors
 - > With **fixed parts** and/or with **skylight**
- ▶ **Leaf-enclosing infills** are available on one side or both sides of the sash
- ▶ Customized **Dr.Hann Rollenband hinges** available, in addition to external and cocealed ones.

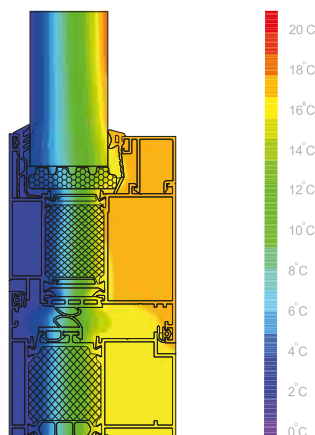

XCLUSIVE 88i² Main Entrance
 Isothermal Flow

27

*One sash construction 1.350mm x 2.500mm.