

8801 1.621 gr/m
6.5m 1.702 gr/m

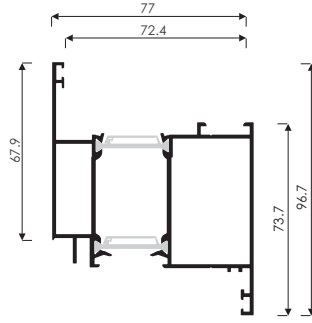

8811AD 1.929 gr/m
6.5m 1.988 gr/m

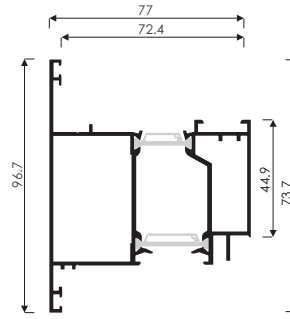

8812AD 1.977 gr/m
6.5m 2.033 gr/m

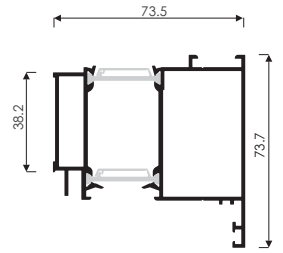

8813AD 1.753 gr/m
6.5m 1.812 gr/m

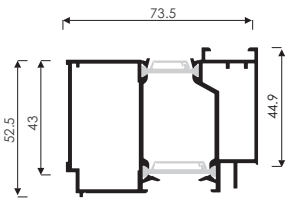

8814AD 1.689 gr/m
6.5m 1.745 gr/m

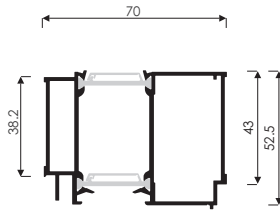

8815AD 1.572 gr/m
6.5m 1.631 gr/m

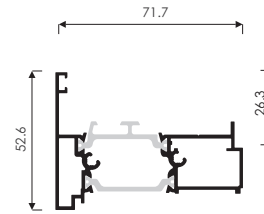

8861 1.245 gr/m
6.5m 1.277 gr/m

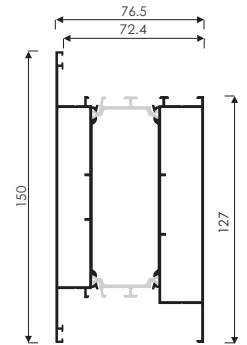

8845 2.935 gr/m
6.5m & 1.2m 3.124 gr/m

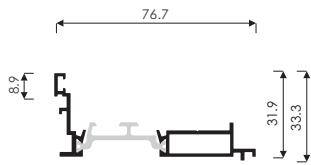

8825 738 gr/m
6.5m

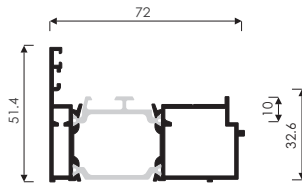

8826 1.255 gr/m
6.5m 1.299 gr/m



1:2
8870 260 gr/m
6.0m & 1.2m



1:2
8871 185 gr/m
6.0m & 1.2m

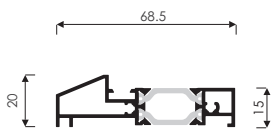

8876 894 gr/m
6.0m & 1.2m 904 gr/m

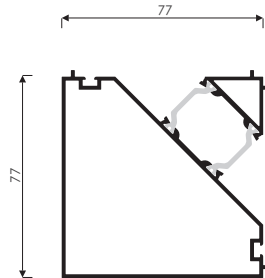

8642 1.784 gr/m
6.0m 1.819 gr/m

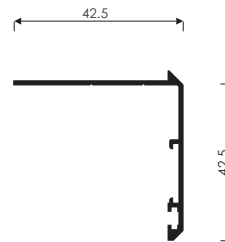

1:2
2080 338 gr/m
6.0m

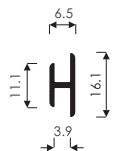

1:2
8034 108 gr/m
6.0m

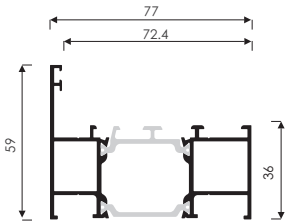

8637 1.463 gr/m
6.5m 1.503 gr/m

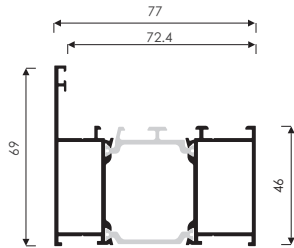

8666 1.640 gr/m
6.5m 1.703 gr/m

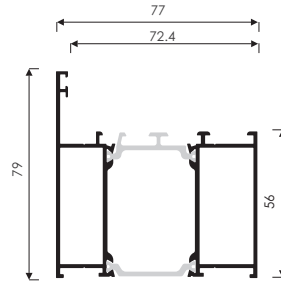

8667 1.831 gr/m
6.5m 1.916 gr/m

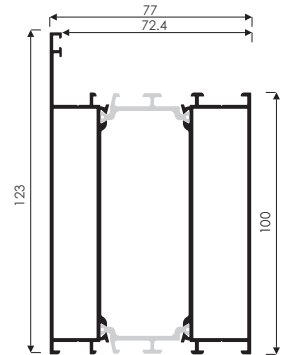

8671 2.636 gr/m
6.5m 2.816 gr/m

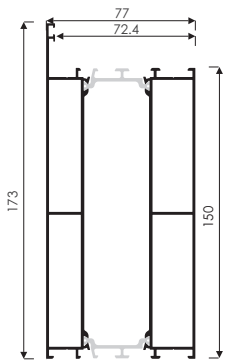

8673 3.684 gr/m
6.5m 3.973 gr/m

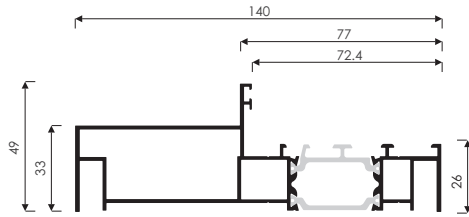

8687 1.995 gr/m
6.5m 2.015 gr/m

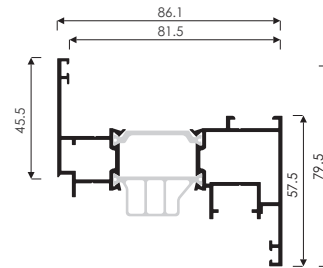

8688 1.719 gr/m
6.5m 1.739 gr/m

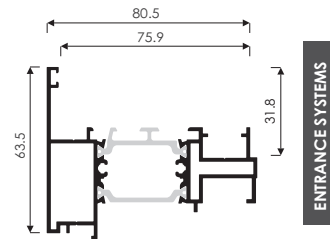

8604 1.633 gr/m
6.5m 1.659 gr/m

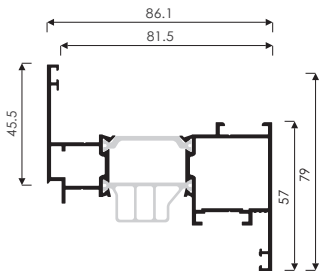

8588 1.678 gr/m
6.5m 1.698 gr/m

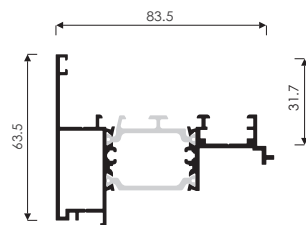

8504 1.478 gr/m
6.5m 1.504 gr/m

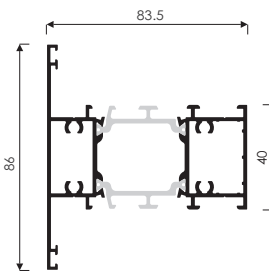

8612 1.786 gr/m
6.5m 1.836 gr/m

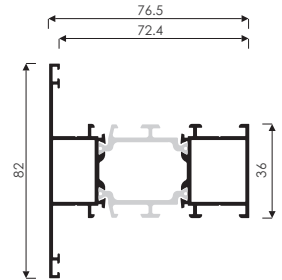

8613 1.531 gr/m
6.5m 1.572 gr/m

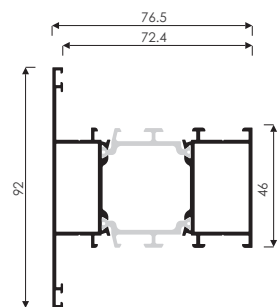

8614 1.704 gr/m
6.5m 1.767 gr/m

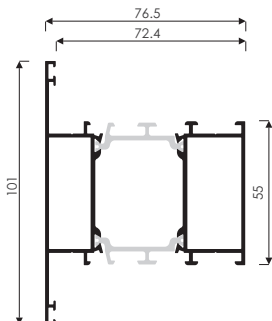

8663 1.869 gr/m
6.5m 1.951 gr/m

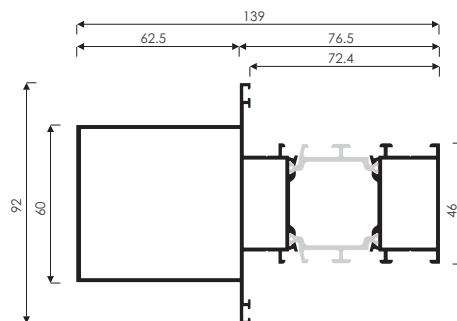

8655 2.494 gr/m
6.5m 2.557 gr/m

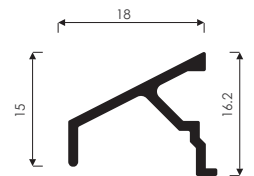

8697 149 gr/m
6.0m

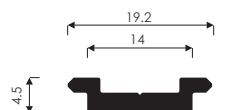

2016 138 gr/m
6.0m

Διάκενο Κάλυψης
Gap Dimension
Razmak

Κωδικός
Code
Šifra

Θεωρητικό Βάρος αβήφου
Theoretical Weight of Unpainted Profile
Teoretska težina na sirove profile

Διάκενο Κάλυψης
Gap Dimension
Razmak

Κωδικός
Code
Šifra

Θεωρητικό Βάρος αβήφου
Theoretical Weight of Unpainted Profile
Teoretska težina na sirove profile

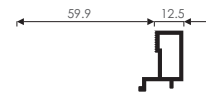

5590

380 gr/m

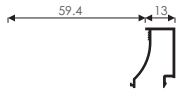

4206B

224 gr/m

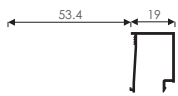

4206E

238 gr/m

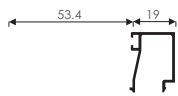

2005

256 gr/m

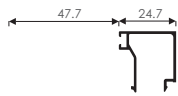

2206

277 gr/m

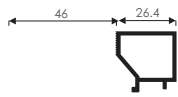

5591

458 gr/m

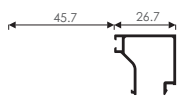

5606

295 gr/m

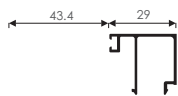

2005B

321 gr/m

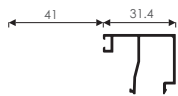

5283

324 gr/m

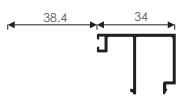

2005A

353 gr/m

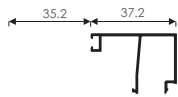

5693

356 gr/m

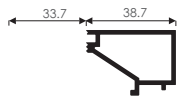

8091

651 gr/m

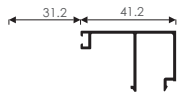

5683

379 gr/m

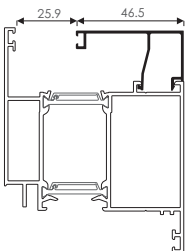

8505

382 gr/m

8811AD & 8812AD

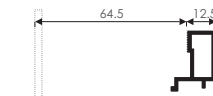

5590

380 gr/m

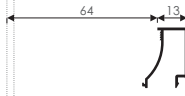

4206B

224 gr/m

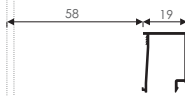

4206E

238 gr/m

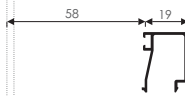

2005

256 gr/m

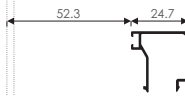

2206

277 gr/m

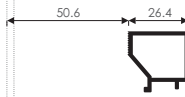

5591

458 gr/m

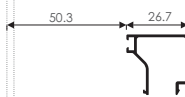

5606

295 gr/m

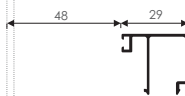

2005B

321 gr/m

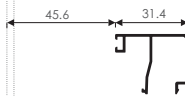

5283

324 gr/m

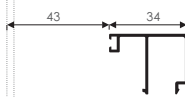

2005A

353 gr/m

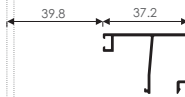

5693

356 gr/m

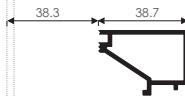

8091

651 gr/m

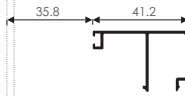

5683

379 gr/m

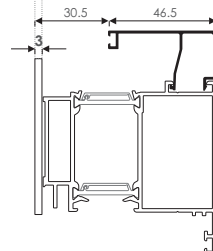

8505

382 gr/m

8813AD & 8814AD

Σημείωση - Note - Napomena

Οι διαστάσεις των πινάκων είναι **ονομαστικές**. Λόγω των ανοχών που υπάρχουν στα προφίλ, στα ελαστικά και στις υαλώσεις, σε κάποιες περιπτώσεις τοποθετείται μικρότερο/μεγαλύτερο ελαστικό ή πηχάκι.
The above dimensions presented in the tables are **nominal**. Due to tolerances of profiles, gaskets and glass, it may be necessary to choose a smaller/greater gasket or glazing bead.
Navedene dimenzije u tabelama su **nominalne**. Zbog tolerancije profila, dihtung gume i stakla, moze biti neophodno da se izabere manja / veća guma ili lajsna za staklo.

ENTRANCE SYSTEMS



ALIGNMENT CORNER - ΓΩΝΙΑ ΕΠΙΠΕΔΟΤΗΤΑΣ - RAVNJAJUČI UGLIĆ						GASKETS - ΕΛΑΣΤΙΚΑ - GUME									
	GE1202.INOX	GE1204.INOX	GE1206	GE1213	GE1216		LP.2000.M	LP.2000.E	LP.8700.1M	LK.8800T.T	LK.8800F.T	LK.8800S.T	LG.8800S	LG.8800F	
P.2	2.500	5.000	10.000	50	50	pcs	P.2	200	200	60	120	90	60	20	20
P.1	250	200	250	-	-	tljx kom	P.1	-	-	20	60	30	30	-	-

JOINT - ΣΥΝΔΕΣΜΟΣ - SPOJNICA				
	CN.8595.330	CN.8796.330	CN.1701SX	CN.1701DX
P.2	100	100	250	250
P.1	20	20	-	-

GROUP	CODE ΚΩΔΙΚΟΣ ΣΙΦΡΑ	JOINT ΣΥΝΔΕΣΜΟΣ SPOJNICA	ALIGNMENT CORNER ΓΩΝΙΑ ΕΠΙΠΕΔΟΤΗΤΑΣ RAVNJAJUČI UGLIĆ	SEALING ΣΤΕΓΑΝΩΣΗ GUMA	CENTRAL GASKET ΚΕΝΤΡΙΚΟ ΕΛΑΣΤΙΚΟ CENTRALNA GUMA	CENTRAL CORNER ΕΛΑΣΤΙΚΗ ΓΩΝΙΑ CENTRALNI UGAO
FRAMES ΚΑΣΕΙ ΣΤΟΚ	8001	EJ +8051.050P +8051.220P	GE1204.INOX	LP.2000.M or - η - III LP.2000.E	LK.8800F	LG.8800F

GROUP	CODE ΚΩΔΙΚΟΣ ΣΙΦΡΑ	JOINT ΣΥΝΔΕΣΜΟΣ SPOJNICA
BOTTOM PROFILE ΤΑΜΠΛΑΣ ΠΑΡΑΡΕΤ	8845	TJ + CN.8595.330 x2 + CN.8796.330 x2 + CN.1701SX + CN.1701DX

ADDITIONAL PROFILES
ΠΡΟΣΘΕΤΑ ΠΡΟΦΙΛ
DODATNI PROFILI

GROUP	CODE ΚΩΔΙΚΟΣ ΣΙΦΡΑ	JOINT ΣΥΝΔΕΣΜΟΣ SPOJNICA	ALIGNMENT CORNER ΓΩΝΙΑ ΕΠΙΠΕΔΟΤΗΤΑΣ RAVNJAJUČI UGLIĆ	SEALING ΣΤΕΓΑΝΩΣΗ GUMA	CENTRAL GASKET ΚΕΝΤΡΙΚΟ ΕΛΑΣΤΙΚΟ CENTRALNA GUMA	CENTRAL CORNER ΕΛΑΣΤΙΚΗ ΓΩΝΙΑ CENTRALNI UGAO
	8825	-	-	LP.2000.M or - η - III LP.2000.E	LK.8800F	LG.8800F
	8826	EJ +4690.050P +4690.260P	GE1204.INOX	LP.2000.M or - η - III LP.2000.E	LK.8800F	LG.8800F

GROUP	CODE ΚΩΔΙΚΟΣ ΣΙΦΡΑ	JOINT ΣΥΝΔΕΣΜΟΣ SPOJNICA	ALIGNMENT CORNER ΓΩΝΙΑ ΕΠΙΠΕΔΟΤΗΤΑΣ RAVNJAJUČI UGLIĆ	GASKET ΕΛΑΣΤΙΚΟ GUMA	CENTRAL GASKET ΚΕΝΤΡΙΚΟ ΕΛΑΣΤΙΚΟ CENTRALNA GUMA	CENTRAL CORNER ΕΛΑΣΤΙΚΗ ΓΩΝΙΑ CENTRALNI UGAO
SASHES ΦΥΛΛΑ ΚΡΙΛΟ	8811AD	EJ +8690.120P +8052.290P	+GE1213 +GE1206	LP.2000.M or - η - III LP.2000.E	LK.8800S	LG.8800S
	8812AD	EJ +8690.120P +8052.290P	+GE1213 +GE1206	LP.2000.M or - η - III LP.2000.E	LK.8800S	LG.8800S
	8813AD	EJ +8690.090P +8052.290P	GE1216	LP.2000.M or - η - III LP.2000.E	LK.8800S	LG.8800S
	8814AD	EJ +8690.120P +8052.220P	GE1216	LP.8700.1M	LK.8800S	LG.8800S
	8815AD	EJ +8690.090P +8052.220P	-	LP.8700.1M	LK.8800S	LG.8800S

ADJOINING PROFILE
ΜΠΙΝ ΦΙΛΙΣΤΩΝ
PROFILI ZA SPAJANJE

GROUP	CODE ΚΩΔΙΚΟΣ ΣΙΦΡΑ	END CAP ΤΑΠΑ ΠΡΟΦΙΛ ΡΟΚΛΟΡΑΣ	SCREW ΒΙΔΑ ΣΡΑΦ	GASKET ΕΛΑΣΤΙΚΟ GUMA	CENTRAL GASKET ΚΕΝΤΡΙΚΟ ΕΛΑΣΤΙΚΟ CENTRALNA GUMA
	8861	P.8861 P.2 75 pair P.1 5 ζεύγη par	3.9X25 DIN 7981	LP.2000.M or - η - III LP.2000.E	LK.8800F

GROUP	CODE ΚΩΔΙΚΟΣ ΣΙΦΡΑ	END CAP ΤΑΠΑ ΠΡΟΦΙΛ ΡΟΚΛΟΡΑΣ	SCREW ΒΙΔΑ ΣΡΑΦ	GASKET ΕΛΑΣΤΙΚΟ GUMA	ALIGNMENT CORNER ΓΩΝΙΑ ΕΠΙΠΕΔΟΤΗΤΑΣ RAVNJAJUČI UGLIĆ
OTHER ΛΟΙΠΑ DRUGO	8870	P.8871 P.2 100 pair P.1 - ζεύγη par	3.9 X 16 DIN 7981 3.5 X 22 DIN 7982	-	-
	8871	P.8871 P.2 100 pair P.1 - ζεύγη par	3.9 X 16 DIN 7981 3.5 X 22 DIN 7982	-	-
	8876	P.8876 P.2 20 pair P.1 - ζεύγη par	3.9 X 16 DIN 7981 3.5 X 22 DIN 7982	LK.8800T	-
	2080	-	-	-	GE1202.INOX

MP - Manual Press / Πρεσάκι / Ručna Presa
PP - Pneumatic Press / Γωνιάστρα / Šipaljka
EJ - Extruded Corner Joint / Πρεσαριστή Γωνία / Ekstrudirana Spojnica
CJ - Casted Corner Joint / Χυτή Γωνία Σύνδεσης / Livnena Spojnica
SJ - Screwing Corner Joint / Βιδωτή Γωνία Σύνδεσης / Spojnica sa šrafom

TJ - Joint for T Profile / Σύνδεσμος ΤΑΦ / Spojnica Prečke
GA - Gasket / Ελαστικό / Guma
CO - Corner / Γωνία / Ugao
P.1 - Big Package / Μεγάλη Συσκευασία / Veliko Pakovanje
P.2 - Small Package / Μικρή Συσκευασία / Malo Pakovanje