

# 5600 ELVIAL MULTILOCK

ELVIAL

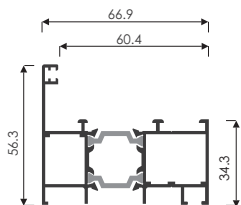

**5637** 1.333 gr/m  
6.0m 1.352 gr/m **I**

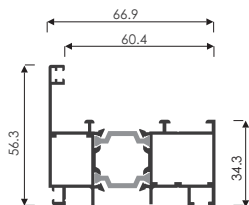

**5627** 1.349 gr/m  
6.0m 1.368 gr/m **I**

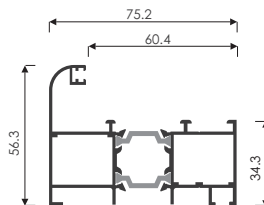

**5630** 1.434 gr/m  
6.0m 1.453 gr/m **I**

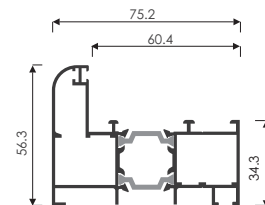

**5629** 1.478 gr/m  
6.0m 1.497 gr/m **I**

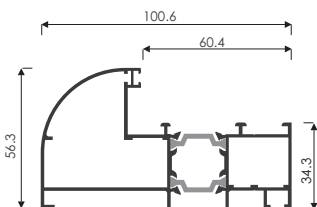

**5656** 1.692 gr/m  
6.0m 1.711 gr/m **I**

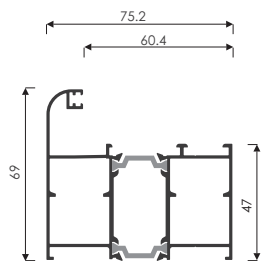

**5265** 1.636 gr/m  
6.0m 1.680 gr/m **I**

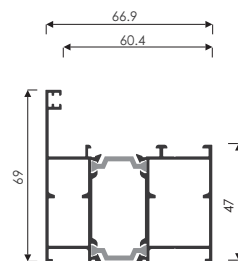

1:3  
**5266** 1.533 gr/m  
6.0m 1.577 gr/m **I**

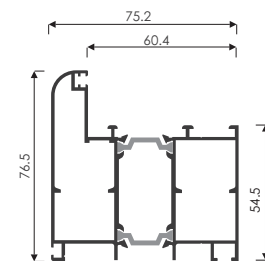

**5607** 1.889 gr/m  
6.0m 1.936 gr/m **I**

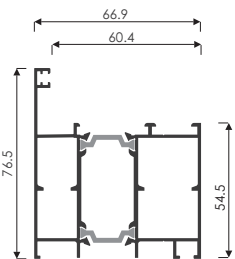

**5666** 1.680 gr/m  
6.0m 1.726 gr/m **I**

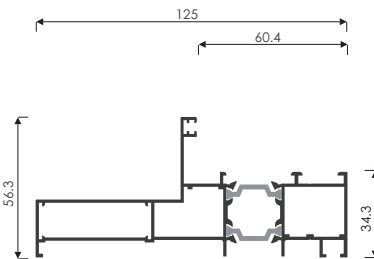

**5687** 1.802 gr/m  
6.0m 1.821 gr/m **I**

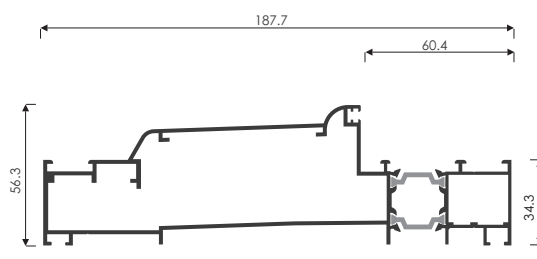

**5619** 2.784 gr/m  
6.0m 2.803 gr/m **I**

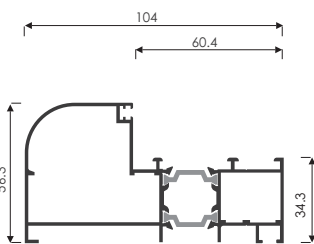

**5652** 1.718 gr/m  
6.0m 1.731 gr/m **I**

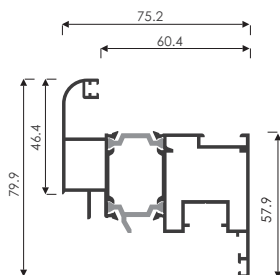

**5608** 1.766 gr/m  
6.0m 1.800 gr/m **I**

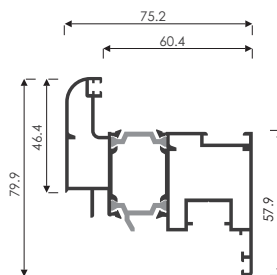

**5609** 1.804 gr/m  
6.0m 1.838 gr/m **I**

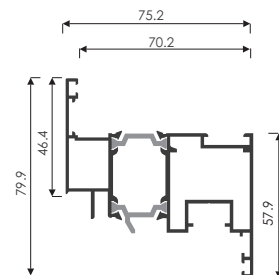

**5688** 1.701 gr/m  
6.0m 1.735 gr/m **I**

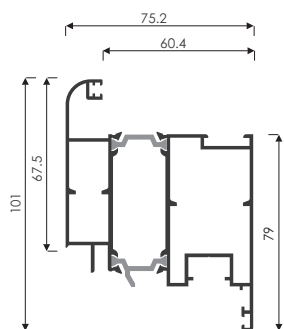

**5659** 2.175 gr/m  
6.5m 2.238 gr/m

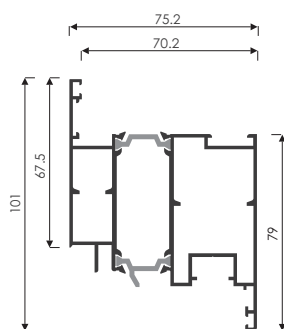

**5686** 2.135 gr/m  
6.5m 2.198 gr/m

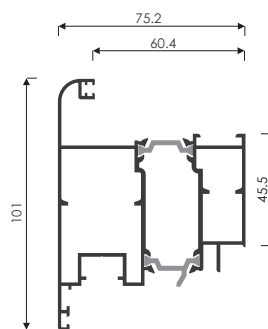

**5610** 2.161 gr/m  
6.5m 2.220 gr/m

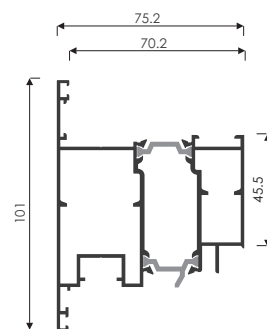

**5685** 2.121 gr/m  
6.5m 2.180 gr/m

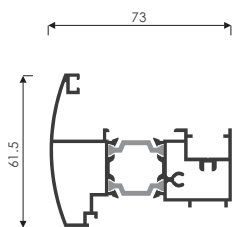

**5634** 1.526 gr/m  
6.0m 1.543 gr/m

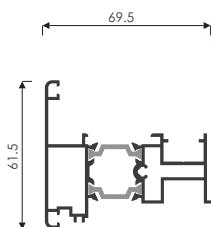

**5604** 1.427 gr/m  
6.0m 1.444 gr/m

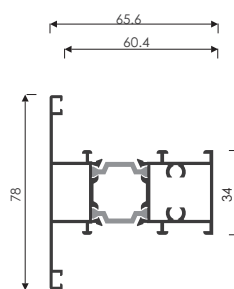

**5212** 1.470 gr/m  
6.0m 1.492 gr/m

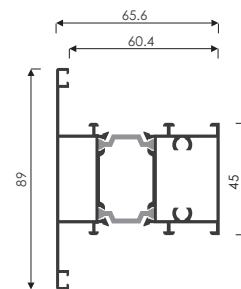

**5261** 1.657 gr/m  
6.0m 1.694 gr/m

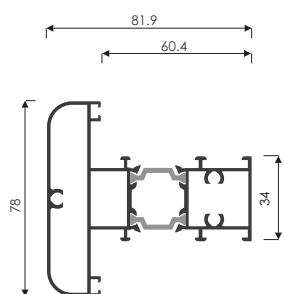

**5254** 1.931 gr/m  
4.6m 1.953 gr/m

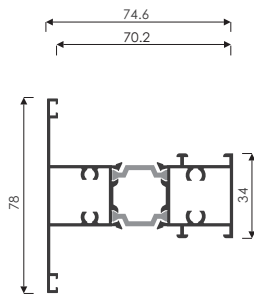

**5684** 1.557 gr/m  
6.0m 1.579 gr/m

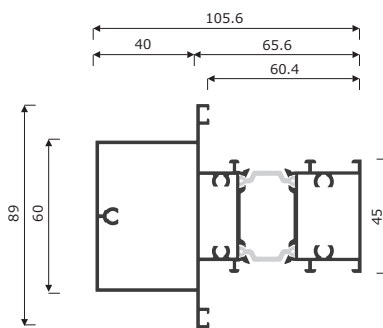

**NEW 5655** 2.365 gr/m  
6.0m 2.402 gr/m

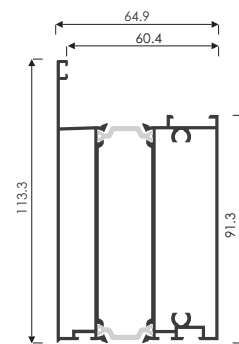

**5205** 2.327 gr/m  
6.0m & 1.2m 2.432 gr/m

Valid only for linear sashes  
Ισχύει μόνο για ίσια φύλλα  
Važi samo za ravna krila

Does not collaborate with linear entrance sashes  
Δεν συνεργάζεται με τα ίσια φύλλα εισόδου  
Ne koristi se sa ravnim krilom

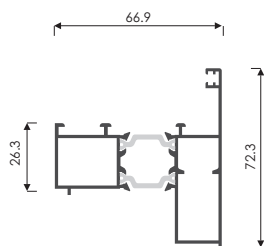

1:3  
**5211** 1.265 gr/m  
6.0m

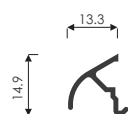

1:2  
**2007** 134 gr/m  
6.0m

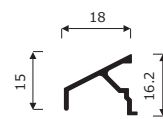

1:2  
**8697** 149 gr/m  
6.0m

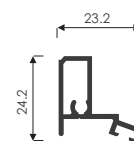

1:2  
**5478** 291 gr/m  
6.0m & 1.2m

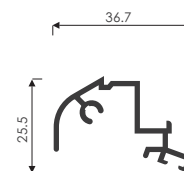

1:2  
**2277** 375 gr/m  
6.0m & 1.2m

# 5600 ELVIAL MULTILOCK

ELVIAL

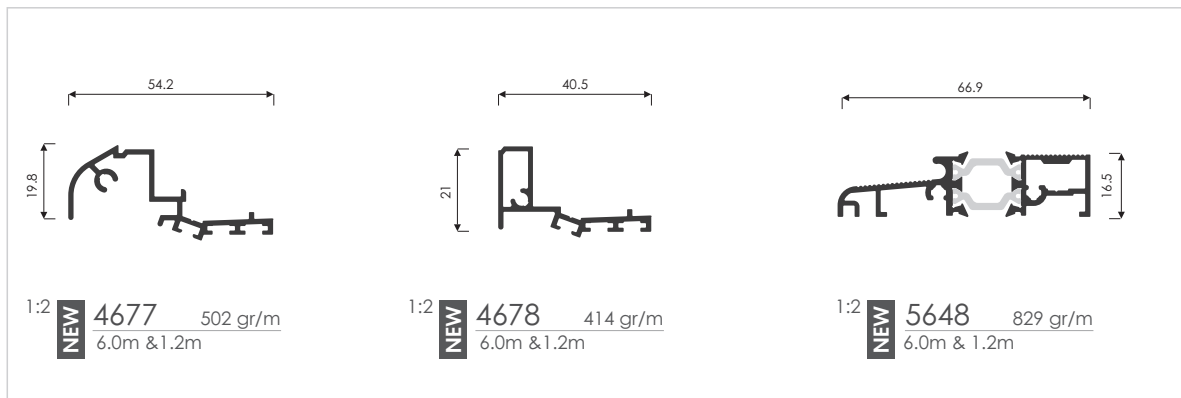
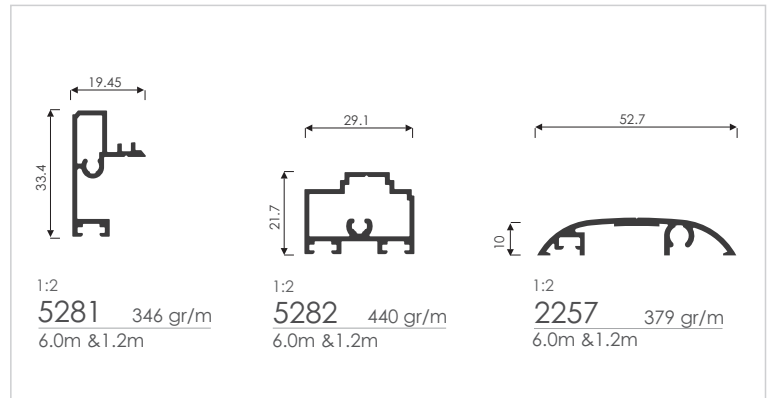
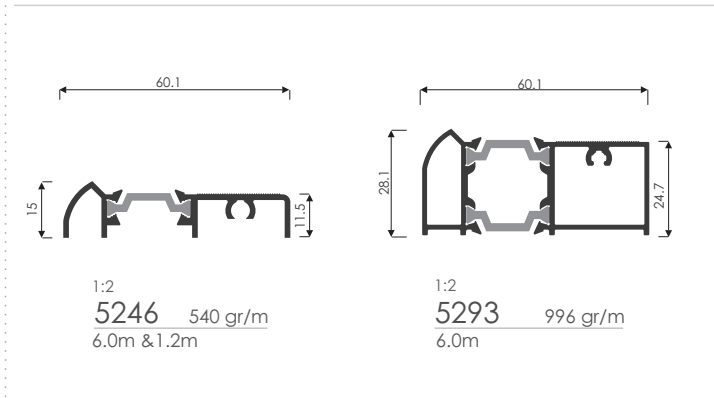

for  
via  
za  
5265  
5607  
5629  
5630

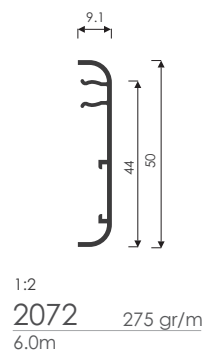
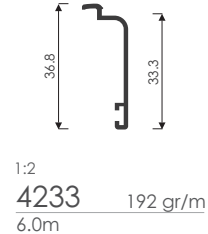
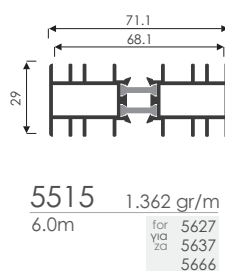
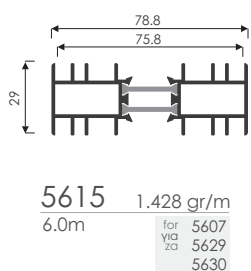
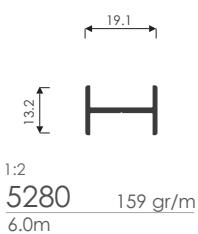
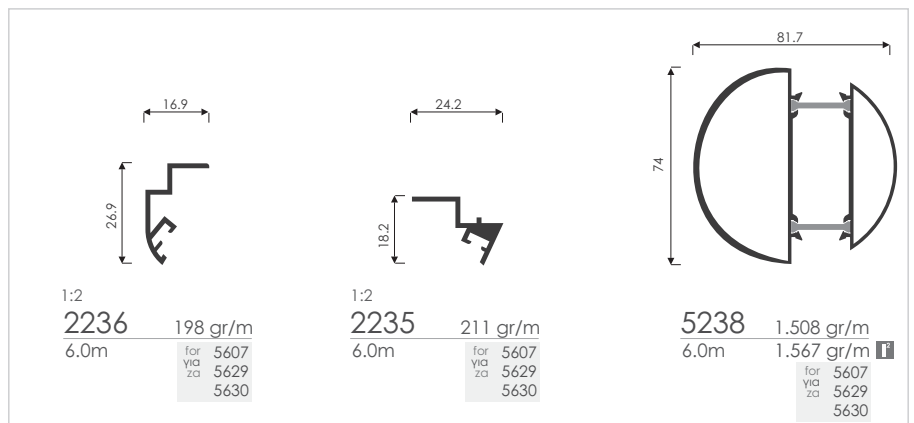
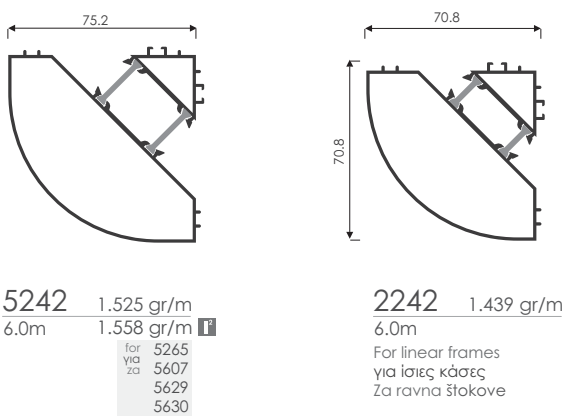

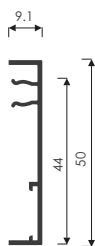

1:2  
**6772** 284 gr/m  
6.0m

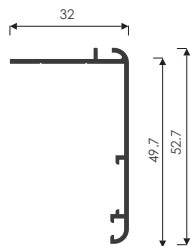

1:2  
**2096** 347 gr/m  
6.0m

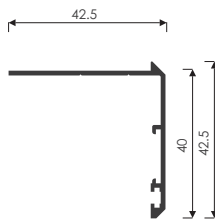

1:2  
**2080** 338 gr/m  
6.0m

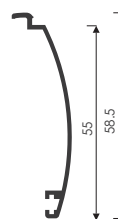

1:2  
**5406** 265 gr/m  
6.0m

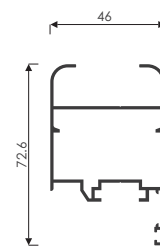

**2110** 934 gr/m  
6.0m

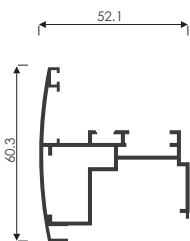

**17677** 876 gr/m  
6.0m

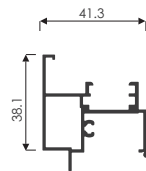

**2133** 686 gr/m  
6.0m

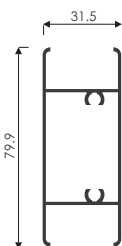

**17678** 878 gr/m  
6.0m

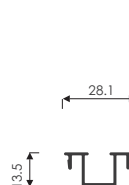

**2049** 232 gr/m  
6.0m



**1030A** 321 gr/m  
6.0m

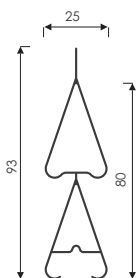

**1083** 538 gr/m  
6.0m

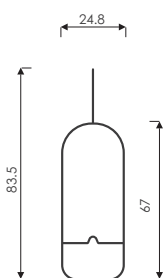

**1084** 438 gr/m  
6.0m

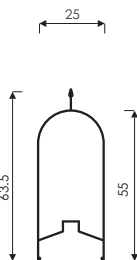

**8141** 387 gr/m  
6.0m

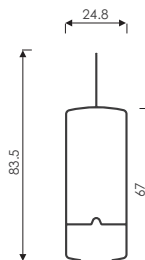

**1087** 460 gr/m  
6.0m

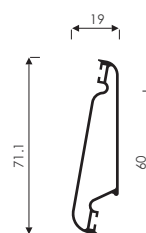

**2104** 532 gr/m  
6.0m



**2105** 417 gr/m  
6.0m

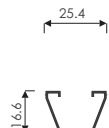

**2106** 180 gr/m  
6.0m

Διάκενο Κάλυψης Gap Dimension Razmak	Κωδικός Code Šifra	Θεωρητικό Βάρος αβάρου Theoretical Weight of Unpainted Profile Teoretska težina na sirove profile	Διάκενο Κάλυψης Gap Dimension Razmak	Κωδικός Code Šifra	Θεωρητικό Βάρος αβάρου Theoretical Weight of Unpainted Profile Teoretska težina na sirove profile
	2302	181 gr/m		2206	277 gr/m
	4305C	212 gr/m		5591	458 gr/m
	4305D	148 gr/m		5606C	299 gr/m
	2319	224 gr/m		5606D	265 gr/m
	5590	380 gr/m		5606	295 gr/m
	4206C	226 gr/m		2005B	325 gr/m
	4206D	213 gr/m		5284	311 gr/m
	4206B	224 gr/m		5283	324 gr/m
	2005C	247 gr/m		2005E	361 gr/m
	2005D	233 gr/m		2005Z	321 gr/m
	4206E	238 gr/m		2005A	353 gr/m
	2005	260 gr/m		5693	356 gr/m
	2290 <small>Only for anodizing Μόνο για ανοδίζωση Samo za eloksovanje</small>	293 gr/m		8091	651 gr/m
	2291	290 gr/m		5683	379 gr/m
	2206C	271 gr/m		8505	382 gr/m

**Σημείωση - Note - Napomena**

Οι διαστάσεις των πινάκων είναι **ονομαστικές**. Λόγω των ανοχών που υπάρχουν στα προφίλ, στα ελαστικά και στις υαλώσεις, σε κάποιες περιπτώσεις τοποθετείται μικρότερο/μεγαλύτερο ελαστικό ή πηχάκι.  
The above dimensions presented in the tables are **nominal**. Due to tolerances of profiles, gaskets and glass, it may be necessary to choose a smaller/greater gasket or glazing bead.  
Navedene dimenzije u tabelama su **nominalne**. Zbog tolerancije profila, dihtung gume i stakla, može biti neophodno da se izabere manja / veća guma ili lajsna za staklo.

For all frames, T profiles except for EL5684  
Για όλες τις κάσες, και τα Tαρ εκτός από το Tαρ EL5684  
Za sve štokove, T prečke izuzev EL5684

Διάκενο Κάλυψης Gap Dimension Razmak	Κωδικός Code Šifra	Θεωρητικό Βάρος αβάρου Theoretical Weight of Unpainted Profile Teoretska težina na sirove profile	Διάκενο Κάλυψης Gap Dimension Razmak	Κωδικός Code Šifra	Θεωρητικό Βάρος αβάρου Theoretical Weight of Unpainted Profile Teoretska težina na sirove profile
	2302	181 gr/m		2206	277 gr/m
	4305C	212 gr/m		5591	458 gr/m
	4305D	148 gr/m		5606C	299 gr/m
	2319	224 gr/m		5606D	265 gr/m
	5590	380 gr/m		5606	295 gr/m
	4206C	226 gr/m		2005B	325 gr/m
	4206D	213 gr/m		5284	311 gr/m
	4206B	224 gr/m		5283	324 gr/m
	2005C	247 gr/m		2005E	361 gr/m
	2005D	233 gr/m		2005Z	321 gr/m
	4206E	238 gr/m		2005A	353 gr/m
	2005	260 gr/m		5693	356 gr/m
	2290 <small>Only for anodizing Μόνο για ανοδίαση Samo za eloksazhu</small>	293 gr/m		8091	651 gr/m
	2291	290 gr/m		5683	379 gr/m
	2206C	271 gr/m		8505	382 gr/m

For linear sashes and T EL5684  
για τα ίσια φύλλα και το Targ EL5684  
za ravna krila i T EL5684

**Σημείωση - Note - Napomena**

Οι διαστάσεις των πινάκων είναι **ονομαστικές**. Λόγω των ανοχών που υπάρχουν στα προφίλ, στα ελαστικά και στις υαλοπίτσες, σε κάποιες περιπτώσεις τοποθετείται μικρότερο/μεγαλύτερο ελαστικό ή πηχάκι.  
The above dimensions presented in the tables are **nominal**. Due to tolerances of profiles, gaskets and glass, it may be necessary to choose a smaller/greater gasket or glazing bead.  
Navedene dimenzije u tabelama su **nominalne**. Zbog tolerancije profila, dihtung gume i stakla, moze biti neophodno da se izabere manja / veća guma ili lajsna za staklo.



ALIGNMENT CORNER ΓΩΝΙΑ ΕΠΙΠΕΔΟΤΗΤΑΣ RAVNJAJUČI UGLIC				SEALING - ΣΤΕΓΑΝΩΣΗ - GUMA				CENTRAL SEALING - ΚΕΝΤΡΙΚΗ ΣΤΕΓΑΝΩΣΗ - CENTRALNA GUMA					
GE1206		GE1201.INOX		GE1202.INOX		GA		CO		GA		CO	
P.2	10.000	10.000	2.500	pcs		LP.5500R		LG.PS.5500R		LK.5600R		LG.5600R	
P.1	250	200	250	ΤΥΧ	kom	P.2	LP.5500RD	P.2	1.000	P.2	LK.5600RD	P.2	250
						P.1	300	P.1	50	P.1	60	P.1	50
							200		50		30		50
							m		50		m		50
							μέτρα		50		μέτρα		50
							m		50		m		50

EXTRAS ΕΞΤΡΑ EXTRAS	
AL.EX.2071	
P.2	600
P.1	200
	pcs
	ΤΥΧ
	kom

GROUP	CODE ΚΩΔΙΚΟΣ ΣΙΦΡΑ	JOINT - ΣΥΝΔΕΣΜΟΣ - SPOJNICA				ALIGNMENT CORNER ΓΩΝΙΑ ΕΠΙΠΕΔΟΤΗΤΑΣ RAVNJAJUČI UGLIC	SEALING - ΣΤΕΓΑΝΩΣΗ - GUMA		CENTRAL SEALING - ΚΕΝΤΡΙΚΗ ΣΤΕΓΑΝΩΣΗ - CENTRALNA GUMA	
		PP	or - ή - ili	MP			GA	CO	GA	CO
FRAMES ΚΑΣΕΤ STOK	<b>5627</b>	←- EJ  4690.150P	→- WINKHAUS EJ  4698.230P	←- -	→- -	GE1201.INOX	LP.5500R	LG.PF.5500R	LK.5600R	LG.5600R
	<b>5637</b>		GU EJ  4690.230P							
	<b>5266</b>		ROTO EJ  4691.230P							
	<b>5666</b>		MACO EJ  4693.230P							
			SIEGENIA EJ  4694.230P							
	<b>5607</b>	EJ  4690.230P	WINKHAUS EJ  4698.230P	-	-	GE1201.INOX	LP.5500R	LG.PF.5500R	LK.5600R	LG.5600R
	<b>5629</b>		GU EJ  4690.230P							
	<b>5630</b>		ROTO EJ  4691.230P							
	<b>5265</b>		MACO EJ  4693.230P							
			SIEGENIA EJ  4694.230P							
	<b>5687</b>	+ EJ  4690.150P SJ  MS219	WINKHAUS EJ  4698.230P	-	-	GE1201.INOX	LP.5500R	LG.PF.5500R	LK.5600R	LG.5600R
			GU EJ  4690.230P							
		ROTO EJ  4691.230P								
		MACO EJ  4693.230P								
		SIEGENIA EJ  4694.230P								

MP - Manual Press / Πρεσάκι / Ručna Presa  
PP - Pneumatic Press / Γωνιάστρα / Štiraljka  
EJ - Extruded Corner Joint / Πρεσαριστή Γωνία / Ekstrudirana Spojnica  
CJ - Casted Corner Joint / Χυτή Γωνία Σύνδεσης / Livena Spojnica  
SJ - Screwing Corner Joint / Βιδωτή Γωνία Σύνδεσης / Spojnica sa Šrafom

TJ - Joint for T Profile / Σύνδεσμος ΤΑΦ / Spojnica Prečke  
GA - Gasket / Ελαστικό / Guma  
CO - Corner / Γωνία / Ugao  
P.1 - Big Package / Μεγάλη Συσκευασία / Veliko Pakovanje  
P.2 - Small Package / Μικρή Συσκευασία / Malo Pakovanje

GROUP	CODE ΚΩΔΙΚΟΣ ŠIFRA	JOINT - ΣΥΝΔΕΣΜΟΣ - SPOJNICA				ALIGNMENT CORNER ΓΩΝΙΑ ΕΠΙΠΕΔΟΤΗΤΑΣ RAVNJAJUĆI UGLIC	SEALING - ΣΤΕΓΑΝΩΣΗ - GUMA		CENTRAL SEALING - ΚΕΝΤΡΙΚΗ ΣΤΕΓΑΝΩΣΗ - CENTRALNA GUMA	
		PP	or - ή - ili	MP			GA	CO	GA	CO
FRAMES ΚΑΖΕΣ ŠTOK	<b>5656</b>	←-	→	←-	→	GE1201.INOX	LP.5500R	LG.PF.5500R	LK.5600R	LG.5600R
		EJ  4690.480P	EJ  4698.230P	-	-					
			WINKHAUS							
			GU							
			EJ  4690.230P							
			ROTO							
		EJ  4691.230P								
		MACO								
		EJ  4693.230P								
		SIEGENIA								
		EJ  4694.230P								
	<b>5652</b>	EJ  4690.520P	EJ  4698.230P	-	-	GE1201.INOX	LP.5500R	LG.PF.5500R	LK.5600R	LG.5600R
		WINKHAUS								
		GU								
		EJ  4690.230P								
		ROTO								
		EJ  4691.230P								
<b>5619</b>	-	-	SJ  MS219	EJ  4698.230P	GE1201.INOX	LP.5500R	LG.PF.5500R	LK.5600R	LG.5600R	
				WINKHAUS						
				GU						
				EJ  4690.230P						
				ROTO						
				EJ  4691.230P						
<b>5211</b>	EJ  2008A.150P	EJ  4698.230P	-	-	GE1201.INOX	LP.5500R	LG.PF.5500R	LK.5600R	LG.5600R	
		WINKHAUS								
		GU								
		EJ  4690.230P								
		ROTO								
		EJ  4691.230P								
	MACO									
	EJ  4693.230P									
	SIEGENIA									
	EJ  4694.230P									

GROUP	CODE ΚΩΔΙΚΟΣ ŠIFRA	JOINT - ΣΥΝΔΕΣΜΟΣ - SPOJNICA				ALIGNMENT CORNER ΓΩΝΙΑ ΕΠΙΠΕΔΟΤΗΤΑΣ RAVNJAJUĆI UGLIC	SEALING - ΣΤΕΓΑΝΩΣΗ - GUMA		CENTRAL SEALING - ΚΕΝΤΡΙΚΗ ΣΤΕΓΑΝΩΣΗ - CENTRALNA GUMA	
		PP	or - ή - ili	MP			GA	CO	GA	CO
ŠASHES ΦΥΛΑΑ KRILLO	<b>5608</b>	EJ  5408A.150P	EJ  5408A.310P	-	-	+ GE1201.INOX GE1206	LP.5500R	LG.PS.5500R	-	-
	<b>5609</b>									
	<b>5659</b>									
	<b>5610</b>									
	<b>5688</b>	EJ  5408A.150P	EJ  5408A.310P	-	-					
<b>5686</b>										
<b>5685</b>										

MP - Manual Press / Πρεσάκι / Ručna Presa  
PP - Pneumatic Press / Γωνιάστρα / Štipaljka  
EJ - Extruded Corner Joint / Πρεσαριστή Γωνία / Ekstrudirana Spojnica  
CJ - Casted Corner Joint / Χυτή Γωνία Σύνδεσης / Livena Spojnica  
SJ - Screwing Corner Joint / Βιδωτή Γωνία Σύνδεσης / Spojnica sa Šrafom

TJ - Joint for T Profile / Σύνδεσμος ΤΑΦ / Spojnica Prečke  
GA - Gasket / Ελαστικό / Guma  
CO - Corner / Γωνία / Ugao  
P.1 - Big Package / Μεγάλη Συσκευασία / Veliko Pakovanje  
P.2 - Small Package / Μικρή Συσκευασία / Malo Pakovanje



GROUP	CODE ΚΩΔΙΚΟΣ ΣΙΦΡΑ	JOINT - ΣΥΝΔΕΣΜΟΣ - SPOJNICA				SCREW ΒΙΔΑ ΣΡΑΦ	SEALING - ΣΤΕΓΑΝΩΣΗ - GUMA		CENTRAL SEALING - ΚΕΝΤΡΙΚΗ ΣΤΕΓΑΝΩΣΗ - CENTRALNA GUMA	
		←	→	←	→		GA	CO	GA	CO
T PROFILE Τ ΠΡΟΦΙΛ T PROFIL	<b>5212</b>	-	-	-	-	4.8 X 50 DIN7981	LP.5500R	LG.PF.5500R	LK.5600R	LG.5600R
	<b>5261</b>									
	<b>5254</b>									
	<b>5655</b>									
	<b>5684</b>	-	-	-	-	4.8 X 50 DIN7981	-	-	-	-
BOTTOM PROFILE ΤΑΜΠΛΑΣ PARAFET	<b>5205</b>	-	-	-	-	4.8 X 50 DIN7981	BR.7X12 P.2 600 m P.1 150 m	-	-	-

GROUP	CODE ΚΩΔΙΚΟΣ ΣΙΦΡΑ	END CAP ΤΑΠΑ ΡΟΚΛΟΡΑΦ	SCREW ΒΙΔΑ ΣΡΑΦ	BRUSH ΒΟΥΡΤΙΣΙΑΚΙ CETKICA	ALIGNMENT CORNER ΓΩΝΙΑ ΕΠΙΠΕΔΟΤΗΤΑΣ RAVNJAJUĆI UGLIĆ	EXTRAS ΕΞΤΡΑ EXTRAS	SEALING - ΣΤΕΓΑΝΩΣΗ - GUMA		CENTRAL SEALING - ΚΕΝΤΡΙΚΗ ΣΤΕΓΑΝΩΣΗ - CENTRALNA GUMA	
							GA	CO	GA	CO
ADJOINING PROFILES ΜΠΙΝΙ LAŽNA PREČKA	<b>5604</b>	P.5604 P.2 100 pcs P.1 25 kom	3.9 X 25 DIN7982	-	-	-	LP.5500R	-	LK.5600R	LM.5600
	<b>5634</b>	P.5634 P.2 200 pcs P.1 25 kom	3.9 X 25 DIN7982	-	-	-	LP.5500R	-	LK.5600R	LM.5600
WATER PROOFING PROFILES ΝΕΡΟΣΤΑΛΑΚΤΕΣ OKAPNICA	<b>8697</b>	P.8697 P.2 100 pcs P.1 1 kom	-	-	-	-	-	-	-	-
	<b>2007</b>	P.2007 P.2 2.500 pcs P.1 100 kom	-	-	-	-	-	-	-	-
ENTRANCE SEALING PROFILES ΠΡΟΣΘΕΤΑ ΦΥΛΛΟΥ ΕΙΣΟΔΟΥ OKAPNICA VRATA	<b>5478</b>	P.5478 P.2 800 pcs P.1 50 kom	3.9 X 25 DIN7982	-	-	-	LP.5500R	-	-	-
	<b>2277</b>	P.2277 P.2 800 pcs P.1 50 kom	3.9 X 25 DIN7982	-	-	-	LP.5500R	-	-	-
THRESHOLDS ΚΑΤΩΚΑΣΙΑ PRAG	<b>5246</b>	P.5246 P.2 250 pcs P.1 25 kom	4.8 X 32 DIN7982	-	-	-	-	-	-	-
	<b>5293</b>	-	3.9 X 25 DIN7981	-	-	-	-	-	-	-
ENTRANCE SEALING PROFILES ΠΡΟΣΘΕΤΑ ΦΥΛΛΟΥ ΕΙΣΟΔΟΥ OKAPNICA VRATA	<b>5281</b>	P.5281 P.2 100 pcs P.1 10 kom	3.9 X 25 DIN7981	BRM.7X8 P.2 700 m P.1 350 m	-	-	-	-	-	-
	<b>5282</b>	P.5282 P.2 100 pcs P.1 10 kom	3.9 X 25 DIN7981	BRM.7X8 P.2 700 m P.1 350 m	-	-	-	-	-	-
	<b>2257</b>	-	4.8 X 32 DIN7981	-	-	-	-	-	-	-
ENTRANCE SEALING PROFILES ΠΡΟΣΘΕΤΑ ΦΥΛΛΟΥ ΕΙΣΟΔΟΥ OKAPNICA VRATA	<b>4677</b>	P.2277 P.2 800 pcs P.1 50 kom	3.9 X 25 DIN7982	BRM.7X8 P.2 700 m P.1 350 m	-	-	-	-	-	-
	<b>4678</b>	P.5478 P.2 800 pcs P.1 50 kom	3.9 X 25 DIN7982	BRM.7X8 P.2 700 m P.1 350 m	-	-	-	-	-	-
THRESHOLDS ΚΑΤΩΚΑΣΙΑ PRAG	<b>5648</b>	P.5648 P.2 100 pcs P.1 20 kom	3.9 X 25 DIN7982	-	-	-	-	-	-	-
COVER PROFILES ΑΡΜΟΚΑΛΥΠΤΡΑ PERVAJZ LAJSNA	<b>2072</b>	-	-	-	GE1202.INOX	ALEX.2071	-	-	-	-
	<b>6772</b>	-	-	-	GE1202.INOX	ALEX.2071	-	-	-	-
	<b>2080</b>	-	-	-	GE1202.INOX	-	-	-	-	-
	<b>2096</b>	-	-	-	GE1202.INOX	-	-	-	-	-